

MONTECITO

2 WAY DIVERTER WITH STOP

Wall mounted 2-Way diverter - F 1/2" NPT
 Facade dinverseur - 1/2" NPT
 Ref #

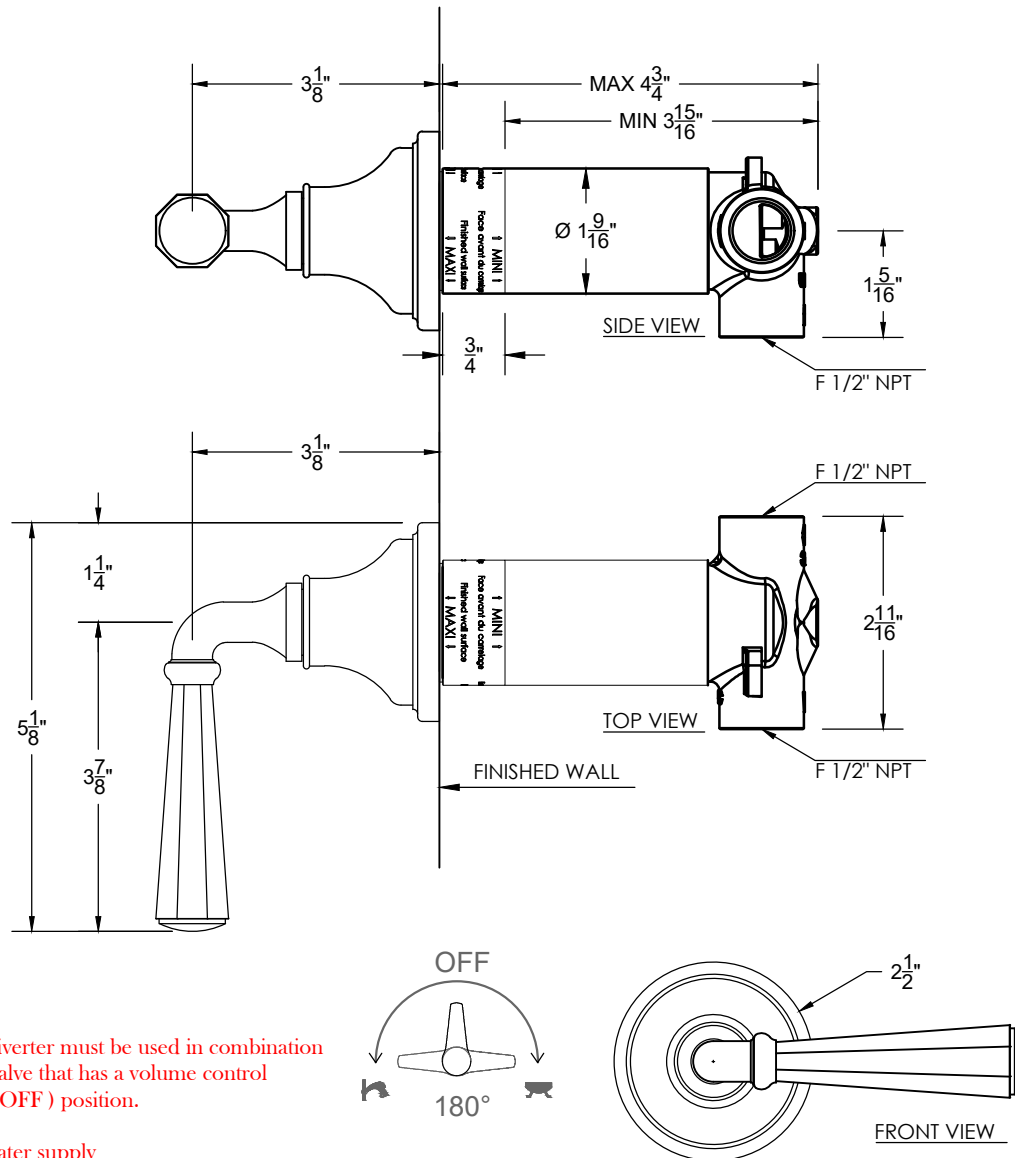

NOTE
 2 way diverter must be used in combination
 with a valve that has a volume control
 (ON | OFF) position.

1 way water supply
 2 way out supplies to other components

Copyright © Compass 2010 www.compassstone.com

 COMPAS™

Revised 01-15-2025

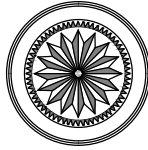

2 WAY DIVERTER

Wall mounted 2-Way Diverter - 1/2" NPT
Facade D' inverseur 2-points - 1/2" NPT
Ref # 0006642

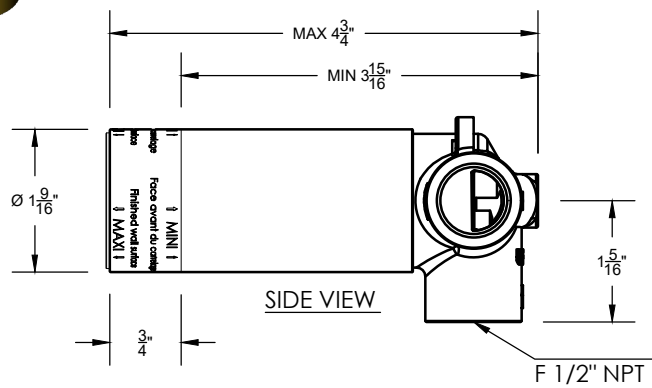
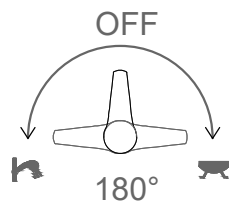
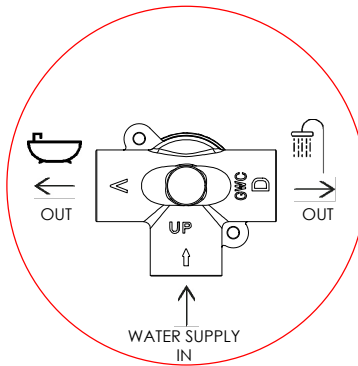
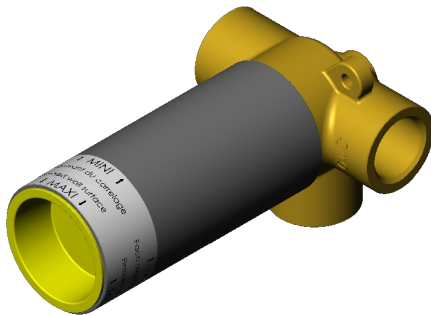

SIDE VIEW

F 1/2" NPT

F 1/2" NPT

DETAIL - A
SCALE - 1 : 1

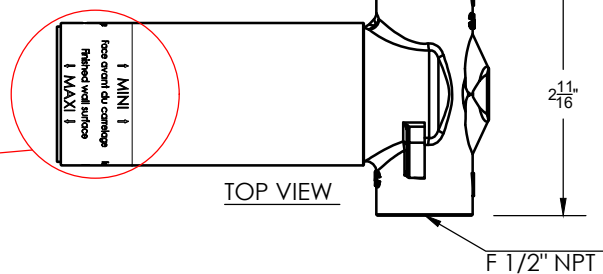
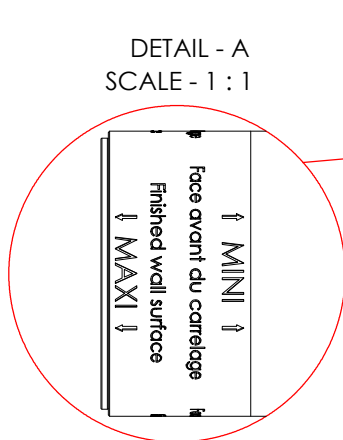

TOP VIEW

F 1/2" NPT